



# City of Carpinteria

Building & Safety Division

## Block Wall Standard

### MUST BE BUILT EXACTLY TO THESE SPECIFICATIONS

#### Specifications:

1. Footings should be level, or if ground slopes, use step footings. Each step should be of a height to fit masonry system. All excavations shall be extended into firm soil and shall be clean and contain no loose earth or foreign matter.
2. Minimum soil bearing to be 1000 psf.
3. For footings and foundations, use concrete with a minimum strength of 2500 psi @ 28 days
4. Grout ASTM C476
5. Mortar mix: Type S  $f'_m=1500$  psi
6. Lap vertical steel 40 bar diameters. (24" minimum)  $f_s=20,000$  psi
7. Concrete masonry units: ASTM C90 Concrete Block, Grade A
8. 4 ft max. lift subject to building inspector verification
9. Walls cannot be reconstructed or newly constructed on property lines

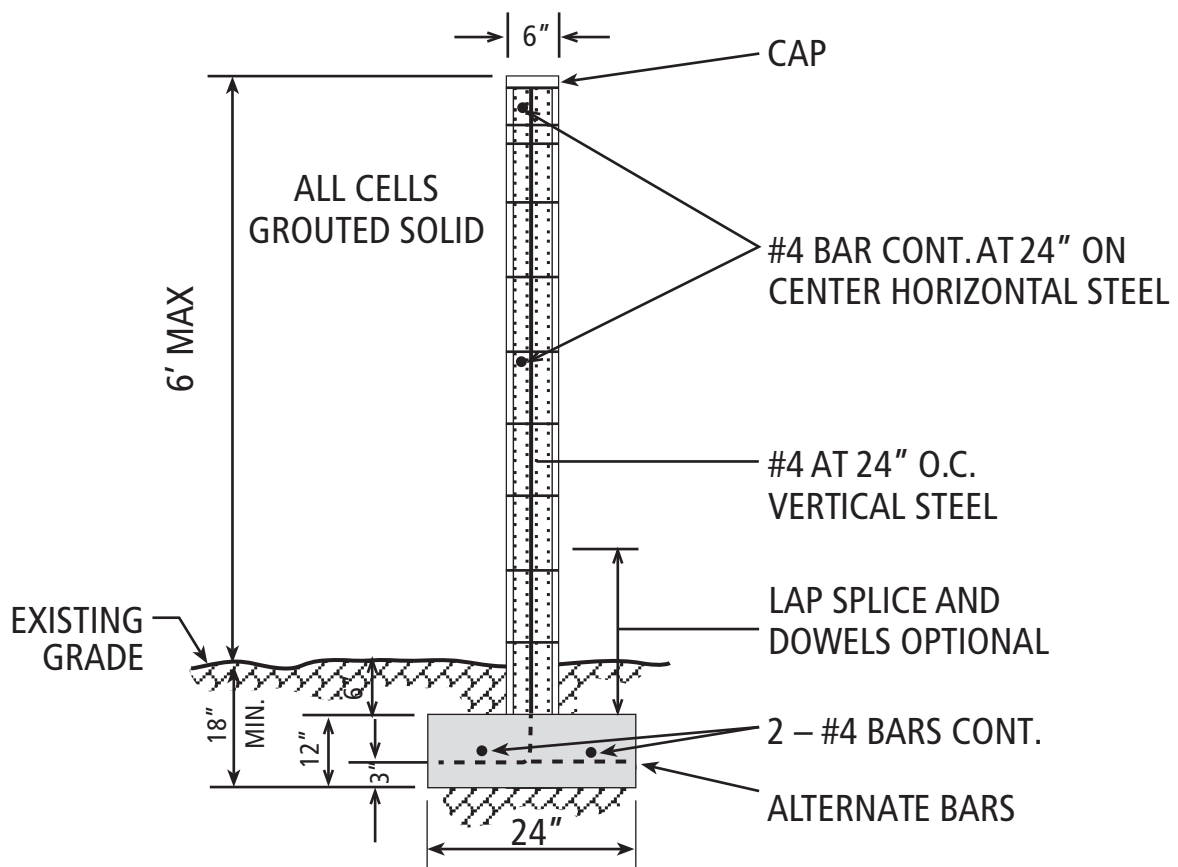

**THIS HANDOUT IS NOT INTENDED TO TAKE THE PLACE OF ANY LAWS OR REGULATIONS**



# City of Carpinteria

Building & Safety Division

## Block Wall Standard (Alternate)

### MUST BE BUILT EXACTLY TO THESE SPECIFICATIONS

#### Specifications:

1. Footings should be level, or if ground slopes, use step footings. Each step should be of a height to fit masonry system. All excavations shall be extended into firm soil and shall be clean and contain no loose earth or foreign matter.
2. Minimum soil bearing to be 1000 psf
3. For footings and foundations, use concrete with a minimum strength of 2500 psi @ 28 days
4. Grout ASTM C476
5. Mortar mix: Type S  $f'_m=1500$  psi
6. Lap vertical steel 40 bar diameters. (24" minimum)  $f_s=20,000$  psi
7. Concrete masonry units: ASTM C90 Concrete Block, Grade A
8. 4 ft max. lift subject to building inspector verification
9. Walls cannot be reconstructed or newly constructed on property lines

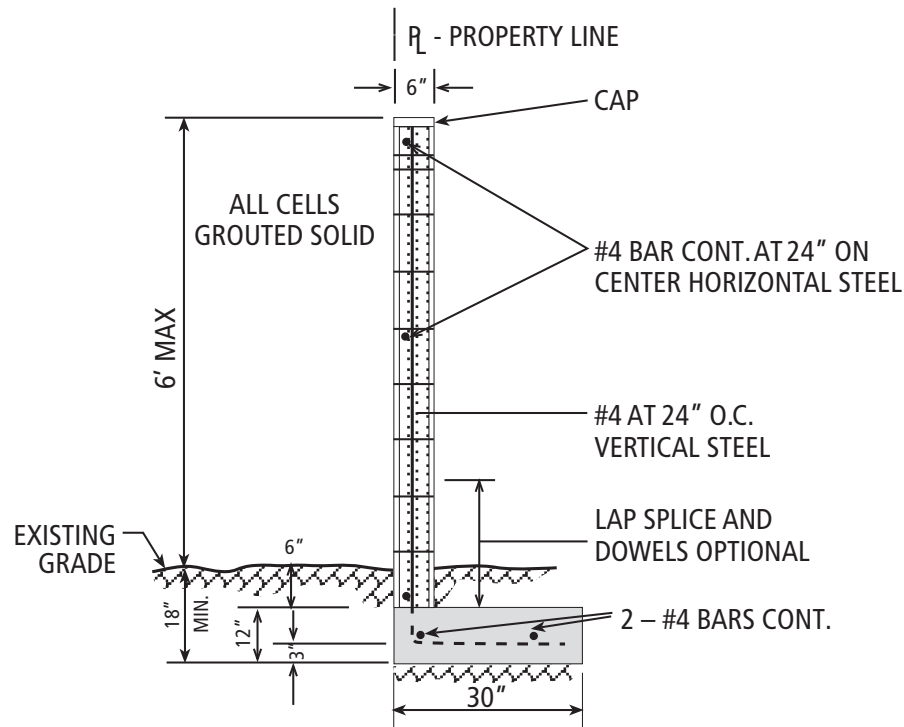

HOURS:

Monday - Friday 8:00 AM - 5:00 PM

LOCATION:

Carpinteria City Hall - 5775 Carpinteria Avenue, Carpinteria, CA 93013

PHONE:

805-684-5405